

Operator's Reference Guide

M230i-S4/S6 & M230i-SP4/SP6

■ SAFETY PRECAUTIONS

The Product Manual must be read before installing and operating your M230i-series equipment. Please read the Safety Precautions chapter carefully before proceeding. The Product Manual is found on the enclosed USB-stick.

Note: *This document is only a complement to the Product Manual.*

WARNING



- **Switch off electrical power and disconnect compressed air before attempting any cleaning or maintenance on the equipment.**
- **Unplug electrical supplies before opening any covers. Potentially lethal voltages are present in this equipment.**
- **Do not pour water or any other liquid directly onto the equipment.**



- **Keep hands, hair, clothing, jewellery, tools etc. well away from moving parts when the equipment unit is operating.**
- **Do not operate the equipment with any of the protective covers removed.**
- **Observe all relevant safety precautions regarding the use of compressed air.**

WARNING



RISK AREA

Risk of pinching

The main risk is pinching fingers when the applicator returns to its home position. Keep hands and fingers away from the machine when it is operating. Switch off power and disconnect air supply before accessing this area.

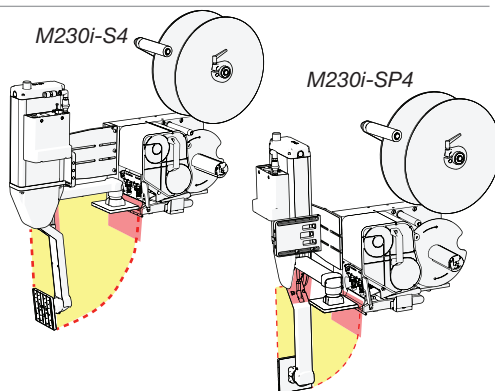

CAUTION



- *Do not probe the equipment's operating parts with sharp or metallic objects as this will cause operating malfunctions and possible damage.*
- *Do not allow abrasive dust particles to enter the printing mechanism, as this will lead to reduced print head life.*
- *Always follow the instructions for changing labels and/or ribbon. Only use approved label and ribbon supplies.*
- *Do not store paper supplies in locations that are subject to direct sunlight, high temperature, high humidity or high dust levels.*
- *Clean the exterior of the equipment by wiping with a dry lint-free cloth or, if necessary, use a mild detergent solution and a damp cloth.*
- *Do not use strong solvents on any surface of the equipment.*

■ POWER ON/OFF

Switch on/off the electrical power using the controller main switch. The main switch is located at the rear of the controller.

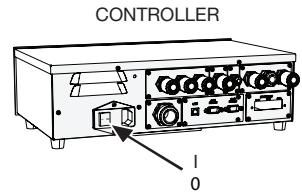

■ PRINTER & APPLICATOR MOTION

| To STOP <i>Carry out one of the actions</i> | To START <i>All actions must be carried out</i> |
|--|--|
| <ul style="list-style-type: none"> • Raise the print head lifting handle. | <ul style="list-style-type: none"> • Lower the print head lifting handle. |
| <ul style="list-style-type: none"> • Press one of the idle/reset buttons for a second to depressurize the applicator. | <ul style="list-style-type: none"> • Press one of the idle/reset buttons for a second to pressurize the applicator. |
| <ul style="list-style-type: none"> • Remove the hood. | <ul style="list-style-type: none"> • Put the hood in place. |
| <ul style="list-style-type: none"> • Pull the shut-off valve upwards to disconnect the compressed air and to depressurize the applicator. | <ul style="list-style-type: none"> • Push the shut-off valve downwards to connect the compressed air and pressurize the applicator. |

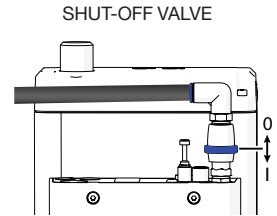

PRINT HEAD LIFTING HANDLE

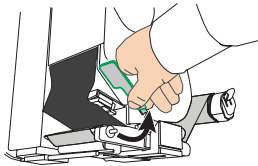

HOOD

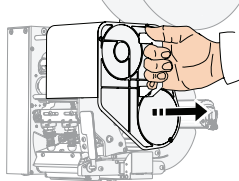

IDLE/RESET BUTTON

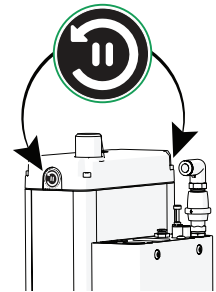

■ CONTROLLER PANEL

Action/Description



Press to enter set-up mode
Press to confirm changes



Press to exit without any changes
Press to step backwards in the menu



Press to go to previous/next menu or item
Press to decrease/increase a value



Press to restart Print & Apply unit
Press to perform a label positioning
Note: This is a configuration, see setup program for more information



Press to print the grey test label
Press long to print currently chosen label
Note: The labels enumeration is not affected



Press to print a label
Depending on configuration: reprint last printed label, print a new label, or not print at all

LEDS**RESET****ERROR****LABEL GAP****POWER****LED lights/flashes to indicate:**

That the system is reset to start the process.

An error in process, for example no labels, no ribbon, print head up etc.

The gap between labels on the roll.

That the power is switched on.

■ LABEL POSITIONING

The positioning of the label can be executed in one of two ways depending on the setup.

- **Head close** (default and recommended method)

Lower the print head lifting handle and press the ENTER button  to feed and position the labels

Note: Raise and lower the print head lifting handle to repeat the label positioning.

- **Reset/Power up**

Press the RESET button  to feed and position the labels.

After label positioning, the printer will have measured the length of the labels and is ready for use.

■ CHANGE RIBBON

1. Raise the print head lifting handle.

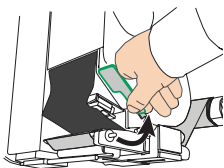

2. Open the peel roller.

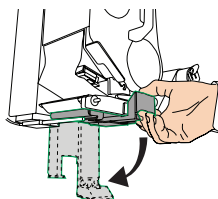

3. Remove the hood.

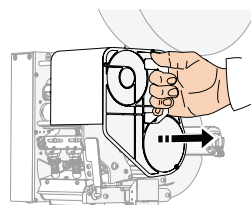

4. Turn the two knobs (a, b) anti-clockwise to release the ribbon rolls.
5. Pull out and remove both rolls.
6. Place an empty roll on the ribbon take-up roll (a).
7. Carefully clean the printer. See page 5 for instructions.
8. Install a new roll of ribbon (b), see threading diagram on the printer for guidance.

Note: The ribbon must NOT pass through the label-gap sensor (c).

Note: Make sure to install ribbon with ink side out.

9. Turn the knobs (a, b) clockwise to secure the ribbon rolls.
10. Lower the print head lifting handle, close the peel roller and put back the hood.
11. Perform a label positioning, see above.

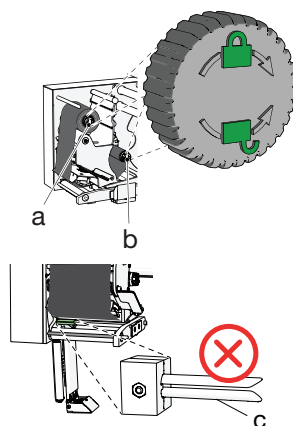

■ CHANGE LABEL ROLL

1. Raise the print head lifting handle and open the peel roller, see page 3.
2. Remove the empty label roll (b).
 - Loosen locking hub (a) on the outer disc.
 - Remove the disc and the empty label roll (b).
3. Remove the backing paper roll (c).
 - Open the slot using the lever and release the backing paper roll.
 - Slide out the backing paper roll.
4. Carefully clean the printer. See page 5 for instructions.
5. Install a new label roll and thread according to the threading diagram on the printer.

Note: Make sure the labels pass through the label-gap sensor (d).

6. Pull the backing paper to the backing paper re-winder.

Note: Make sure this part of the backing paper is free from labels and glue residue.

- Put the backing paper into the slot (e).
- Close the slot using the lever (f). Make sure it is properly closed.
- Turn the roller until the backing paper is tight (g).

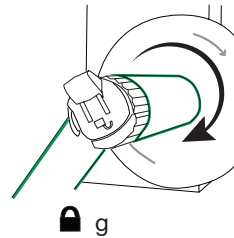
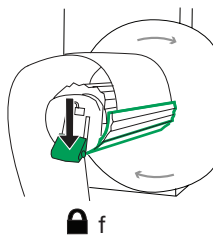
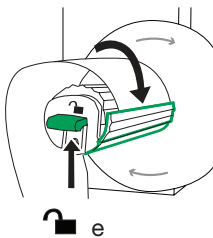
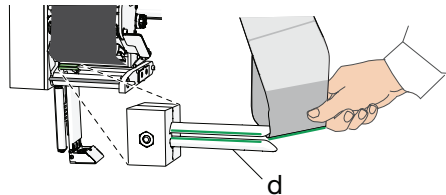
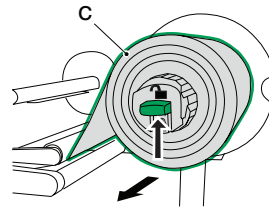
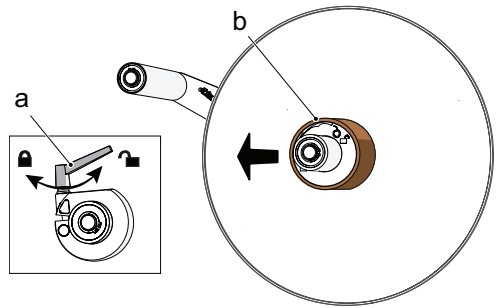

7. Lower the print head lifting handle and close the peel roller.
8. Perform a label positioning, see page 3.

MAINTENANCE

Caution: NEVER use any hard, metallic or abrasive objects to remove, adhesives or other contaminants from the print head or any other parts.

Note: Use only manufacturer's approved cleaning wipes for cleaning the printer.

Before cleaning printer

1. Switch off electrical power and air supply.
2. Raise the print head lifting handle.
3. Open the peel roller.

Move applicator

Move the applicator out of the way to facilitate printer service. Press either idle/reset button (a) and move the applicator arm (b) by hand.

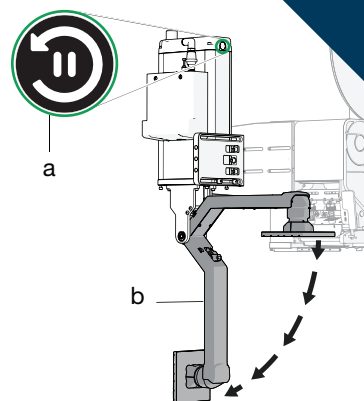

M230i-SP4

Clean print head

Clean the print head (d) after every roll of ribbon.



1. Lightly blow or brush away any loose dust and lint particles within the print mechanism.
2. Use the cleaning wipes to wipe the print head.

Clean platen roller and ribbon take-up roller



1. Gently ease out the labels/ribbon sideways.
2. Rub the cleaning wipes along the platen roller (f)/ ribbon take-up roller (c) and slowly turn the roller by hand until the roller is completely clean.

Note: The electrical power must be off to make it possible to manually turn the roller.

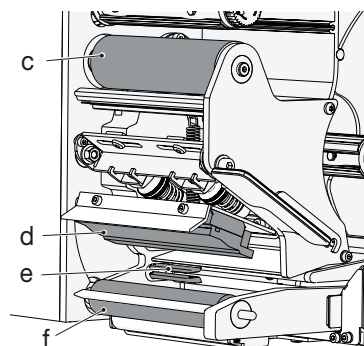

- c. Ribbon take-up roller
- d. Print head
- e. Label-gap sensor
- f. Platen roller

Clean label-gap sensor

Clean all paper dust and label parts from the label-gap sensor (e) with compressed air, a small brush or the plastic nozzle of a vacuum cleaner.

Caution: Be careful not to bend the sensor when cleaning it.

Note: Check that the label-gap sensor is parallel to the label.

After cleaning the label gap sensor perform a label positioning, see page 3.

Clean exterior and applicator pad

Clean the exterior of the equipment by wiping with a dry lint-free cloth or, if needed, use a damp cloth and a mild detergent solution.

Remove all dirt, debris and glue residue from the pad using "Label off" spray, or a similar spray for this, avoid spraying on any rubber rollers.

■ BASIC CLEANING & MAINTENANCE SCHEDULE

See Print & Apply Product Manual for more information.

| DAILY SCHEDULE (10 minutes) ... | WEEKLY SCHEDULE (10-20 minutes) |
|--|--|
| Clean exterior of equipment. | Carry out DAILY schedule. |
| Clean applicator (applicator pad, etc.). | Check friction of backing paper re-winder. |
| Clean assisting blow tube. | Check platen roller and ribbon take-up roller for damage and dirt. |
| Clean label-gap sensor. | Check function of machine stop or emergency stop (if fitted). |
| Check position of applicator pad. | |
| Check that label position is 1mm from dispensing beak. | |
| Check motion of applicator. | |
| Check air pressure. | |
| Check vacuum filter in applicator module replace if necessary. | |
| ... OR WHEN CHANGING MEDIA | MONTHLY SCHEDULE (20-30 minutes) |
| Clean print head. | Carry out DAILY & WEEKLY schedules. |
| Clean platen roller and ribbon take-up roller. | Check function of the label-gap sensor. |
| | Check tension of the drive belts. |
| | Check drive belts for wear. |
| | Check print head for missing dots. |
| | Check alignment between applicator and dispenser beak. |

■ TROUBLESHOOTING - FIRST CHECK

Before calling a technician, please check the following problem solutions.

| PROBLEM AREA | POSSIBLE CAUSE |
|---|---|
| Printer fails to print. | Power/air supply not switched on. |
| | Mains cable is loose. |
| | Print head is up. |
| | Print hood is not fitted correctly. |
| | Peel roller is open. |
| | Labels and ribbon are not correctly threaded. |
| | Applicator is not in "home position". |
| Poor print quality. | Machine stop/emergency stop triggered. |
| | Print head is dirty. |
| | Platen roller is damaged or dirty. |
| Labels do not stop in the correct position. | Incorrect label and/or ribbon material. |
| | Labels are slipping on the rollers. Clean all rollers. |
| | Label-gap sensor requires calibration. |
| | Platen roller is worn. |
| Ribbon rewind does not operate correctly. | Labels are incorrectly threaded. |
| | Ribbon is incorrectly threaded. |
| Ribbon wrinkles. | Print head wires are touching the ribbon. |
| | Ribbon is incorrectly threaded. |