

Dx1060i CO₂ Laser Coder

Coding with the energy of light

Cutting-edge laser technology that adds a power reserve to boost reliability and longevity, while also providing an ideal solution for coding difficult substrates and handling extremely high production speeds.

Meeting Industry 4.0 standards the **Dx1060i** integrates seamlessly into your production environment. Options for automated label deployment, remote monitoring, and diagnostics via Domino's cloud-based services help to reduce human intervention, errors and downtime, enabling you to achieve regulatory compliance and meet market demands.



100 watt laser power to drive your success

For line integration:

- ◆ More than 50 standard beam delivery options, a 360° rotatable scanhead, and customization options for specific needs.
- ◆ Seamless integration into ERP, WMS, and MES systems.
- ◆ Web-based user interface and easy operation via an intuitive HMI.

For tough environments:

- ◆ Dusty, wet, sticky – no problem with IP54/IP65 printheads and IP55 controller for protection.
- ◆ Performs at 45°C ambient temperature.

For performance:

- ◆ Advanced coding algorithm increases coding speed* by up to 30% while maintaining superior code quality.
- ◆ Options for coding automation, **R-Series** vision control, and near real-time remote monitoring and diagnostics via Domino's cloud-based services help to ensure only perfectly coded products enter the supply chain.

Pushing the boundaries of precision and performance

Power is key to increase speed while achieving superior print quality.



Pin-sharp codes on plastic materials, ideal for wide marking fields



Excellent code quality on glass and other demanding materials



Marking speeds up to 90k bottles per hour on paper labels



GS1 compliant codes for serialization

*coding speed depends on the individual application; **Dx-Series** has been benchmarked against Domino **D-Series**

www.domino-printing.com

Domino. Do more.



A complete solution

Our services are designed to provide operational insight so you can eliminate downtime and maximize production efficiency.

Operational support

An outstanding level of care, wherever you are. Our **SafeGuard** packages provide high-quality, on-site assistance and AR-enabled remote guidance from our engineers. **SafeGuard** helps to ensure we can be with you when you need us most.

Automatic code inspection

Ensure every code that leaves your factory is present and correct, and free up operator time. With the **R-Series**, Domino's range of vision control systems, you can automate your code inspection to validate code presence, placement, and readability.

Automation

Centralize your label management: **Domino Automation** easily integrates into your manufacturing process as well as your ERP/MES systems. It makes automatic changeovers safe and simple, helping you to reduce waste and drive sustainability initiatives while increasing productivity and efficiency.

Smart production

Gain operational insight by connecting your printer to Domino's cloud-based services. Obtain production analytics dashboards and receive system error alerts. Our cloud service provides you with the information you need to run your operations more efficiently.

Domino experts at your side

From finding the best solution to installation and support throughout the lifetime of your Domino laser coding systems our experts are at your side.

- ◆ **Testing:** We use a scientific approach to analysing substrates and samples to help ensure that we find the ideal laser for your application.
- ◆ **Safety:** is paramount when operating laser systems: laser guarding, extraction to remove potentially damaging particles, proper installation, prevention of access in operation – we have you covered.
- ◆ **Support:** **Dx-Series** lasers rarely need attention, but if, we're here to help. We utilize AR to troubleshoot issues remotely; if on-site support is needed, our technicians will come prepared to get your line running as fast as possible.



Technical specification **Dx-Series** Coding System

Laser Type	Dx1060i
Laser technology	CO ₂
Laser source	100W, wavelengths 9.3, 10.2, 10.6µm
Expected lifetime	50,000h MTBF
Coding Format	
Coding content	Laser optimized fonts for high-speed marking and standard industrial fonts. Graphics, logos, standard industrial machine readable code (1D, 2D) formats (DataMatrix, GS1, QR). Intuitive GS1 Digital Link support. Supporting traceability with serialization data, sequential and batch numbering. Synchronized clock / Network Time Protocol support (NTP).
Focal length	from 80mm to 600mm
Marking field	from min. 57x57mm ² to max. 379x582mm ²
Advanced Features	Aiming beam, Aim & Code
User Interface	
User Interface	Web based user interface, option to configure multiple parallel access points, optional 10.1" touch panel
Interface Options	Domino Cloud Interface (DCI), Domino Automation
System Specification	
Scan head orientations	Multitude of scan head orientations including 360° rotatable variant. More than 50 beam orientation variants. Additionally support for customization and solution integration.
Ingress Protection	Laser Module: IP54 certified fan cooled, optional IP65 certified water cooled Controller: IP55
Operating temperature	5°C - 45°C
Operating humidity	max. 90% RH, non-condensing
Electrical supply	multivoltage 90-264V, 50/60Hz
Input and Outputs, Interfaces	
Inputs/outputs	Multiple inputs and outputs available e.g. extractor, compressed air kit, water chiller, encoder, product detect (NPN, PNP), beacon and interlocks, standard GPIO, additional optional GPIO available.
Interfaces/Protocols	Ethernet, USB, Dynamark Protocol, EtherNet/IP™, RS-232, EDC
Options	
Software	Advanced and Remote Security Pack (21CFR Part11 / Annex11), near realtime external data capture (EDC)
Accessories	Extraction including optimized shrouds, airknife for lens cleaning, multiple brackets, cables and stands for integration support
Certification	Marking: CE**, cTUVus, UKCA / Fulfills requirement: NRTL, ROHS, FDA listed, EMC, FCC

** Partly Completed Machinery as per Machinery Directive (2006/42/EC), CE marking according to ROHS (2011/65/EU) and EMC (2014/30/EU)

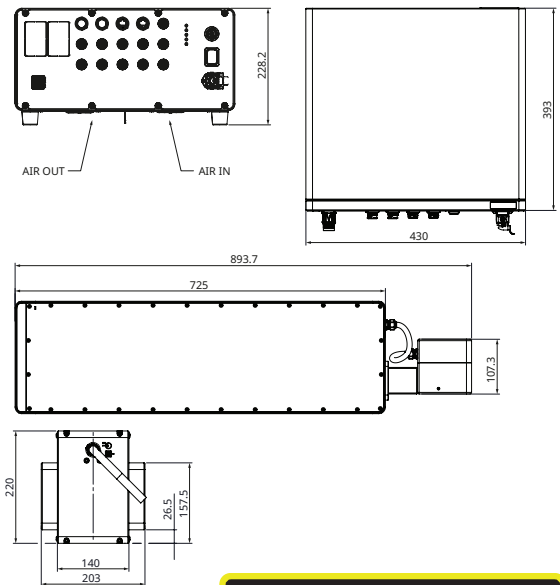

TALK TO AN EXPERT

800.444.4512
solutions@domino-na.com
www.domino-na.com/contact